

## 03-15 PROPELLER SHAFT

### PROPELLER SHAFT

LOCATION INDEX ..... 03-15-1

### PROPELLER SHAFT

REMOVAL/INSTALLATION ..... 03-15-2

Propeller Shaft Removal Note.....03-15-2

Propeller Shaft Installation Note .....03-15-3

PROPELLER SHAFT INSPECTION ....03-15-3

### PROPELLER SHAFT LOCATION INDEX

A5U031525002W01

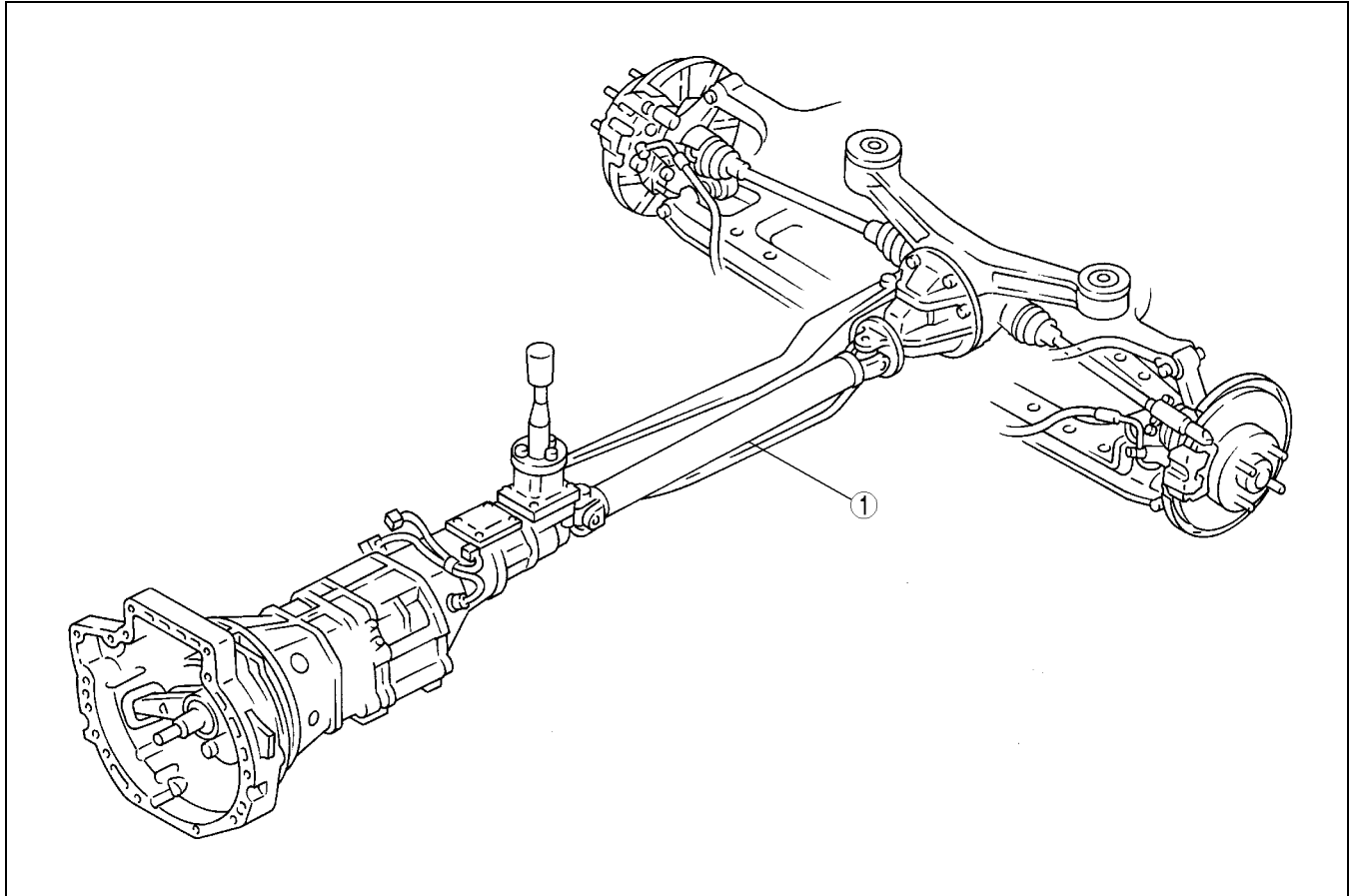

A5U0315W001

03-15

|   |   |
|---|---|
| 1 | Propeller shaft<br>(See 03-15-2 PROPELLER SHAFT REMOVAL/<br>INSTALLATION)<br>(See 03-15-3 PROPELLER SHAFT INSPECTION) |
|---|---|

A5U031525002W02

1. Remove the crossmember bracket. (See 02-14-9 CROSSMEMBER BRACKET REMOVAL/INSTALLATION.)
2. Remove the rear crossbar (only vehicle equipped with 16 inch wheel). (See 03-14-4 DIFFERENTIAL REMOVAL/INSTALLATION.)
3. Remove the presilencer. (See 01-15-1 EXHAUST SYSTEM REMOVAL/INSTALLATION.)
4. Remove in the order indicated in the table.
5. Install in the reverse order of removal.

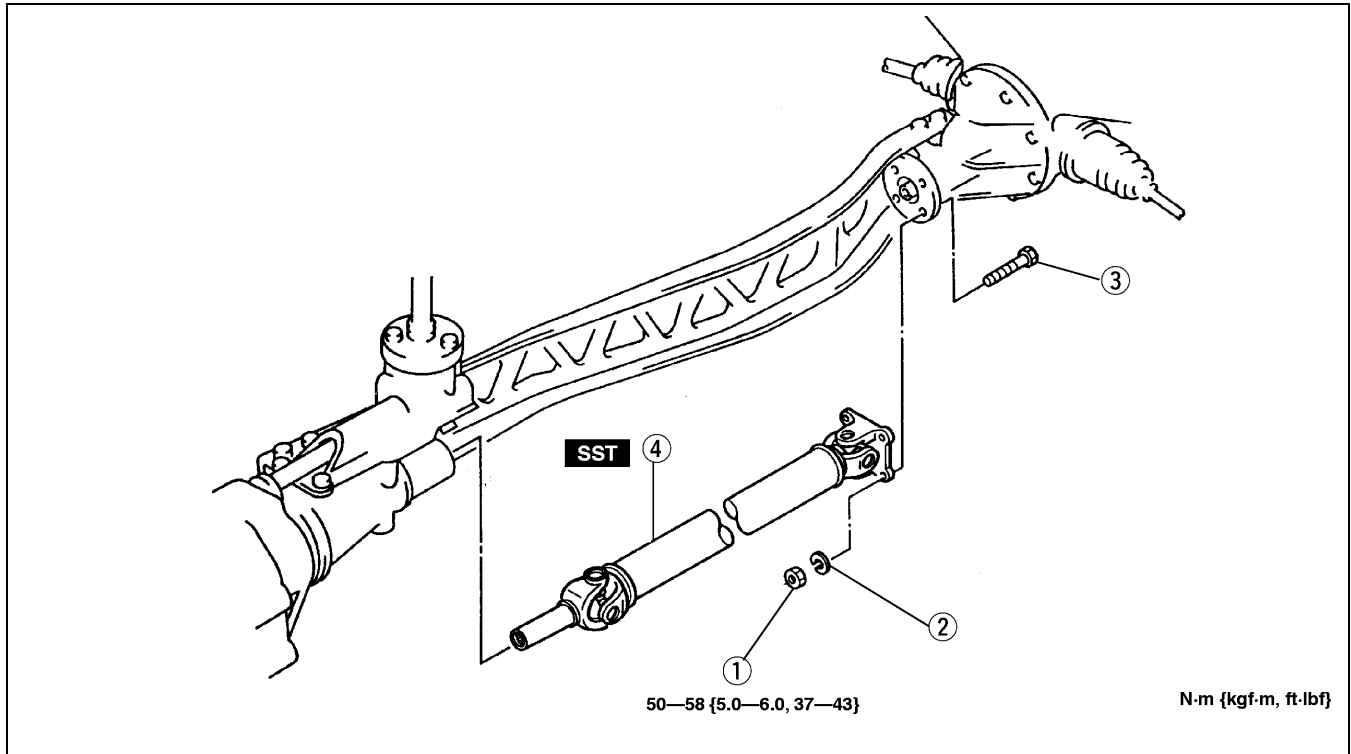

X5U315WA0

|   |             |
|---|-------------|
| 1 | Nut         |
| 2 | Lock washer |
| 3 | Bolt        |

|   |  |
|---|--|
| 4 | Propeller shaft<br>See 03-15-2 Propeller Shaft Removal Note<br>See 03-15-3 Propeller Shaft Installation Note |
|---|--|

1. Before removing the propeller shaft, mark the flanges for correct installation.

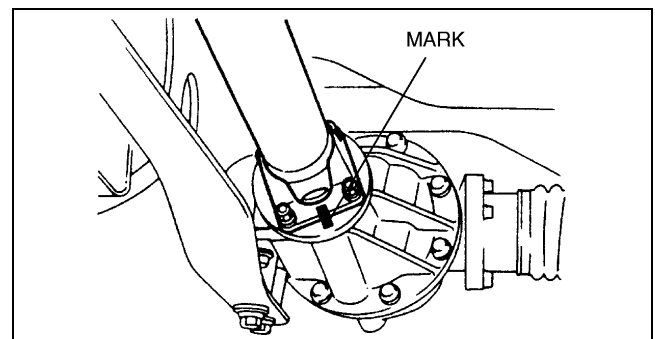

X5U315WA1

## PROPELLER SHAFT

2. Remove the propeller shaft from the extension housing, and immediately install the **SST** to prevent oil leakage.

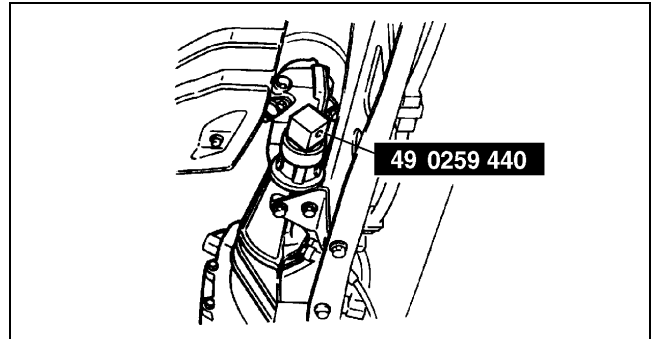

Z5U0315W130

03-15

### Propeller Shaft Installation Note

1. Align the marks made during removal, and install the propeller shaft.
  - If installing a new propeller shaft, align the differential companion flange precast marking with the tag on the propeller shaft.

#### Tightening torque

**50—58 N·m {5.0—6.0 kgf·m, 37—43 ft·lbf}**

2. Verify that there is no abnormal noise or vibration when driving the vehicle.
  - If noise or vibration comes from the propeller shaft, replace the propeller shaft.

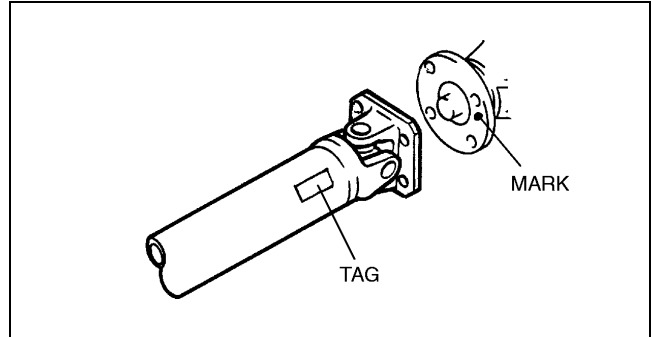

X5U315WA3

### PROPELLER SHAFT INSPECTION

1. Clean the propeller shaft (except for the universal joint) with a steam cleaner or solvent.

A5U031525002W03

#### Caution

- **Cleaning sealed bearings with cleaning fluids or a steam cleaner can wash the grease out of the bearing.**
2. Measure the propeller shaft runout using a dial indicator. Replace the propeller shaft if runout is excessive.

#### Maximum runout

**0.4 mm {0.016 in}**

3. Move the universal joints in the directions shown, and check for universal joint looseness.
  - If there is looseness, replace the propeller shaft.

#### Note

- Starting torque: **0.30—0.98 N·m {3.0—10.0 kgf·cm, 2.7—8.6 in·lbf}**
4. Inspect for operation of the universal joint.
    - If the universal joint has excessive resistance, replace the propeller shaft.

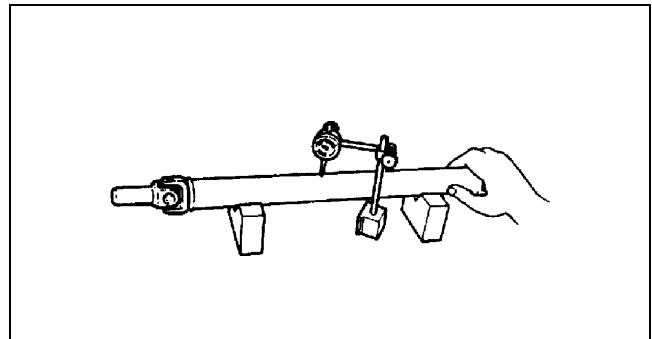

X5U315WA4

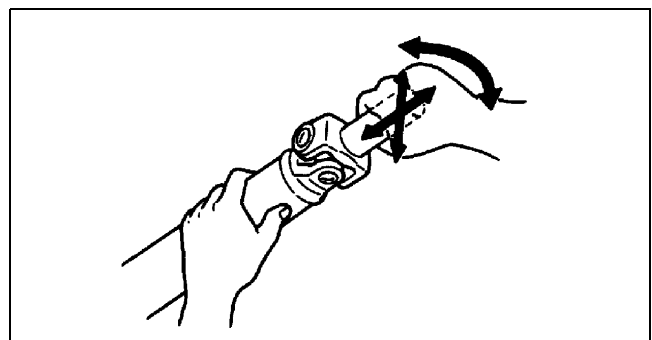

X5U315WA5