

## SIDE PANEL NO.4 REINFORCEMENT (ASSY) REPLACEMENT

1. REMOVE FRAME REAR UPPER CROSSMEMBER (See page BP-62)
2. REMOVE SIDE PANEL NO.4 REINFORCEMENT

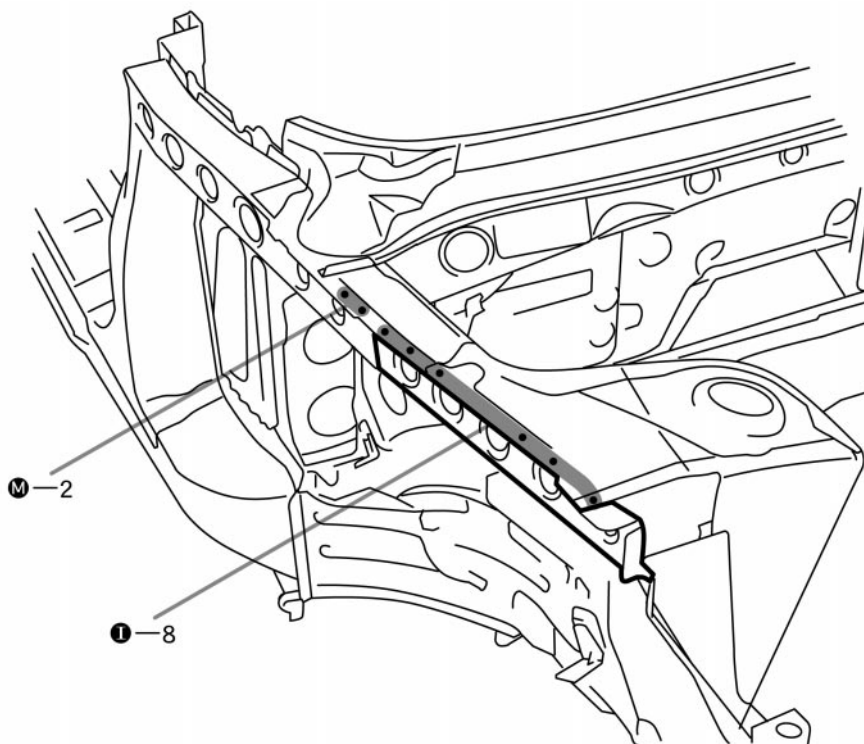
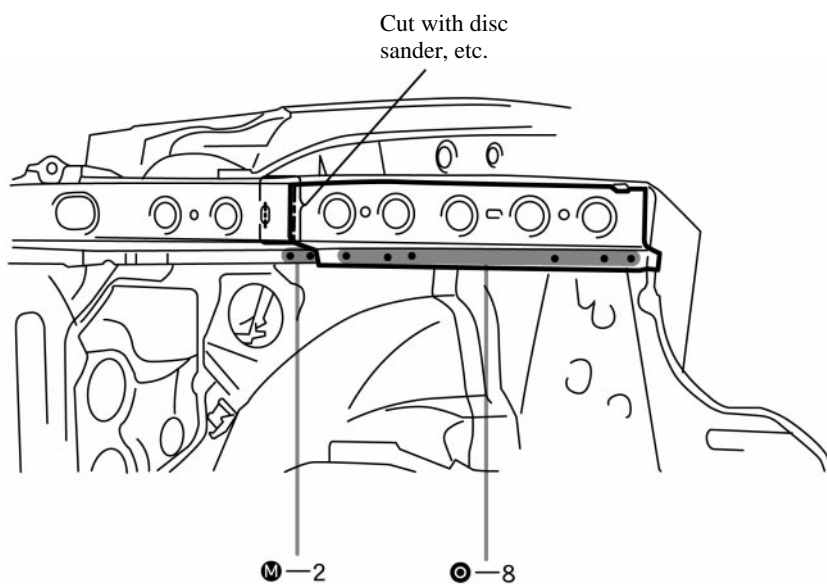
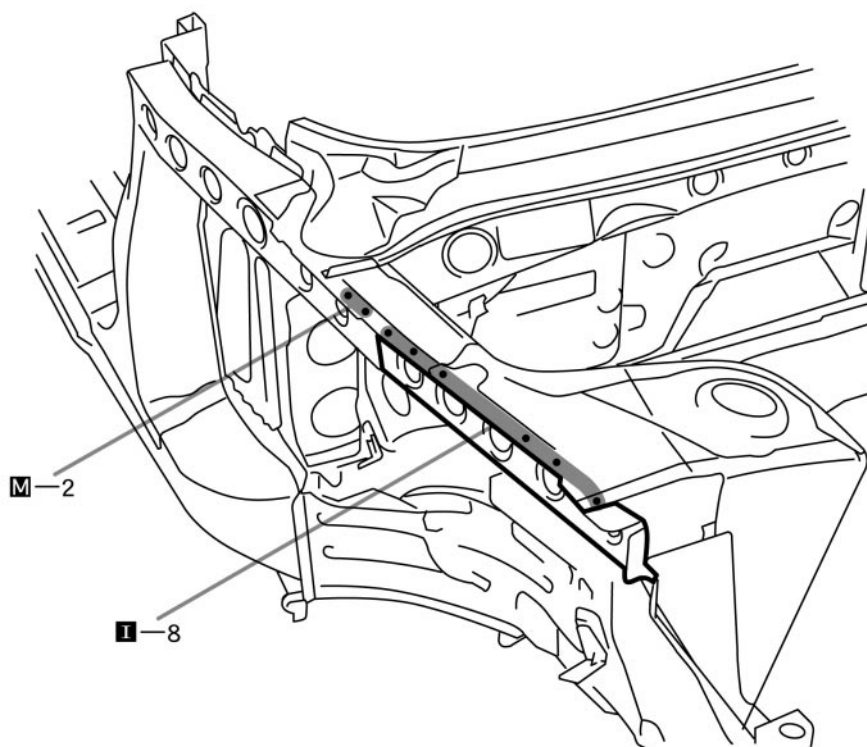
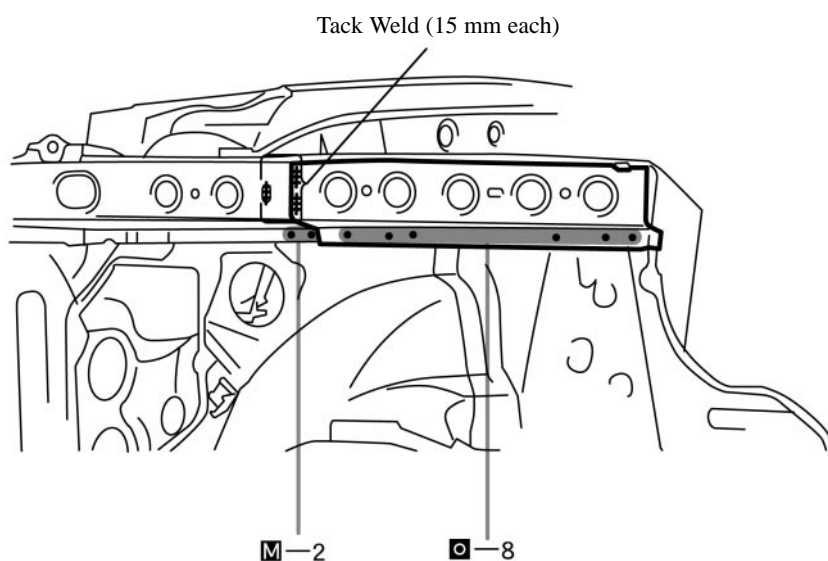

**3. INSTALL SIDE PANEL NO.4 REINFORCEMENT**

mm	in.
15	0.59

- 
4. **INSTALL FRAME REAR UPPER CROSSMEMBER (See page BP-63)**
  5. **APPLYING SEALER TO THE ENGINE COMPARTMENT (See page PC-1)**
  6. **APPLYING ANTI-RUST AGENT**
    - (a) After applying the top coat layer, apply the anti-rust agent to the inside of the necked section structural weld spots.