

BODY LOWER BACK PANEL (ASSY)

REPLACEMENT

1. REMOVE BODY LOWER BACK UPPER PANEL (See page BP-58)
2. REMOVE BODY LOWER BACK PANEL

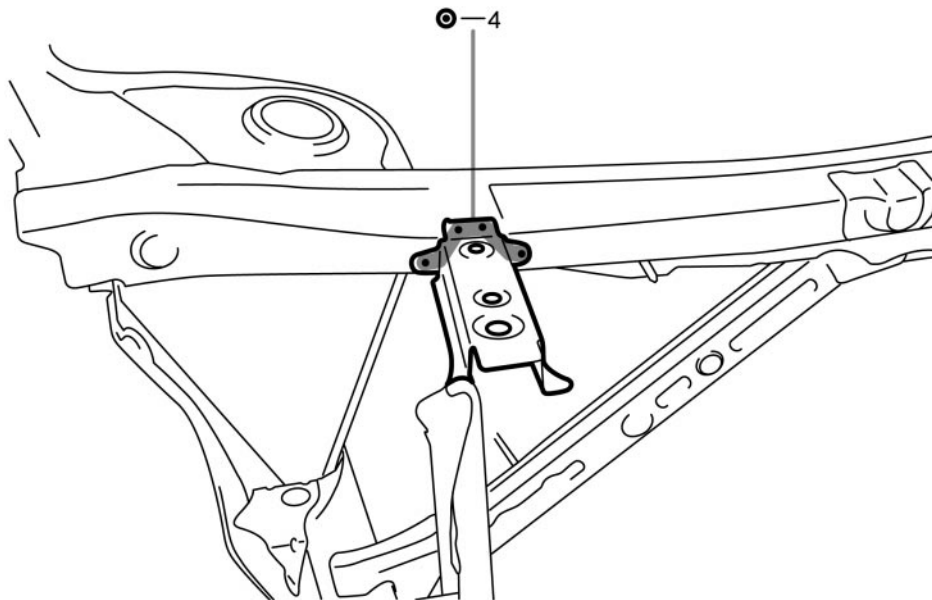
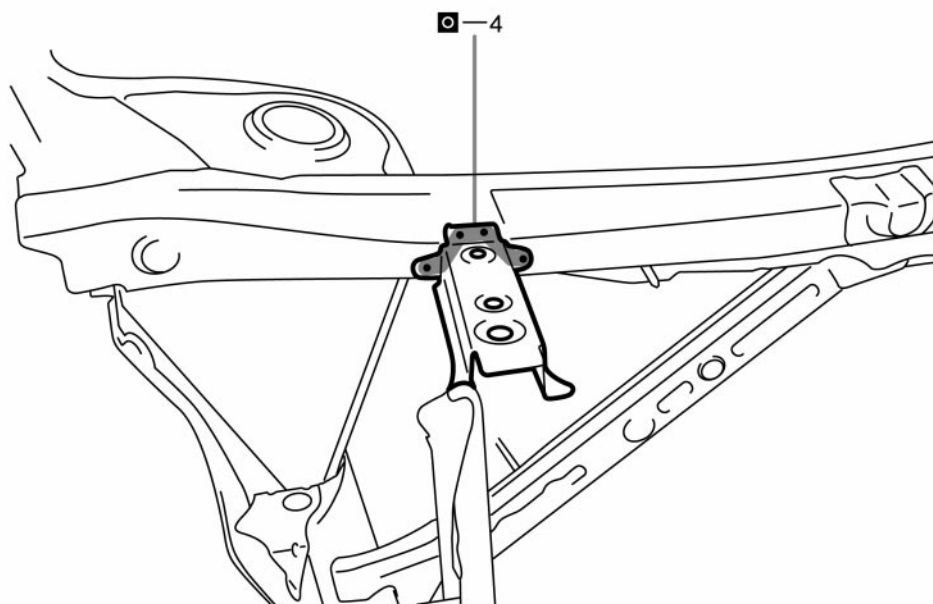

3. INSTALL BODY LOWER BACK PANEL

F10846A

- 4. INSTALL BODY LOWER BACK UPPER PANEL (See page BP-59)**
- 5. APPLYING SEALER TO THE ENGINE COMPARTMENT (See page PC-1)**
- 6. APPLYING ANTI-RUST AGENT**
 - (a) After applying the top coat layer, apply the anti-rust agent to the inside of the necked section structural weld spots.