

# REAR DIAGONAL MEMBER (ASSY)

## REPLACEMENT

### 1. REMOVE REAR DIAGONAL MEMBER

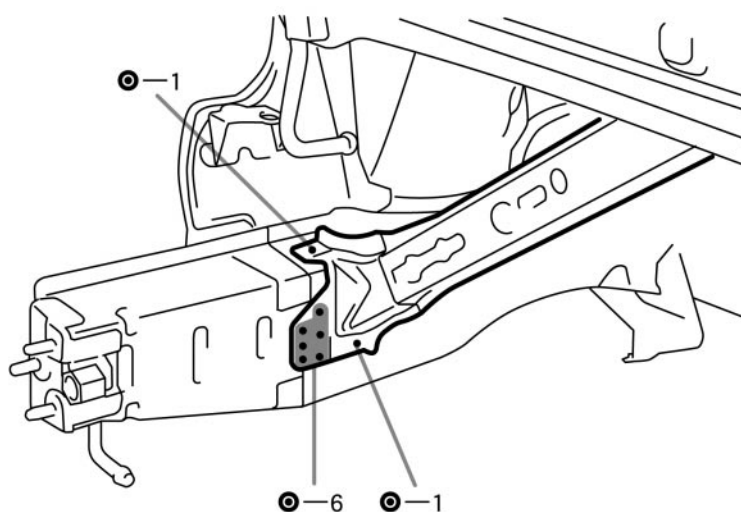
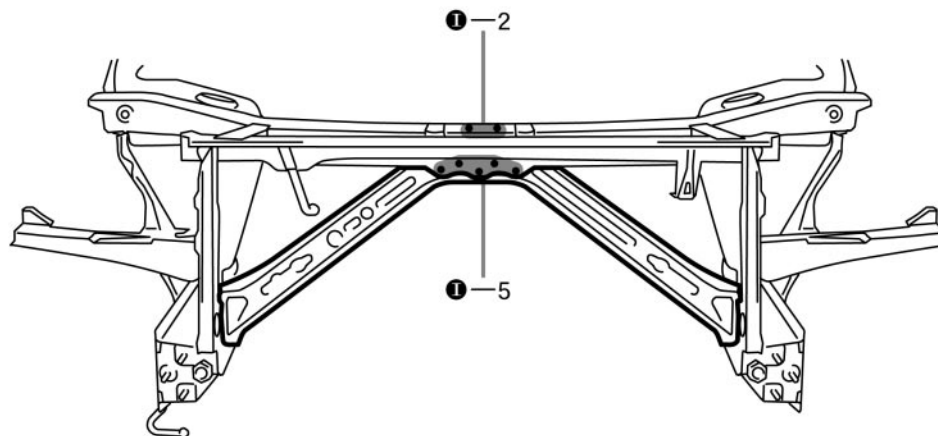
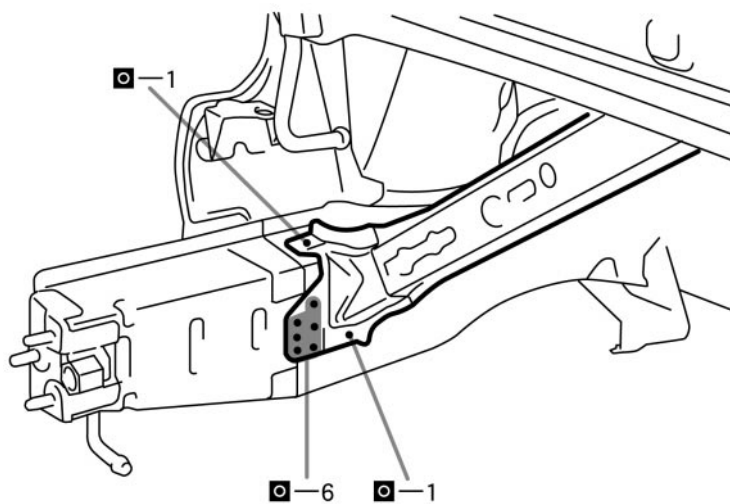
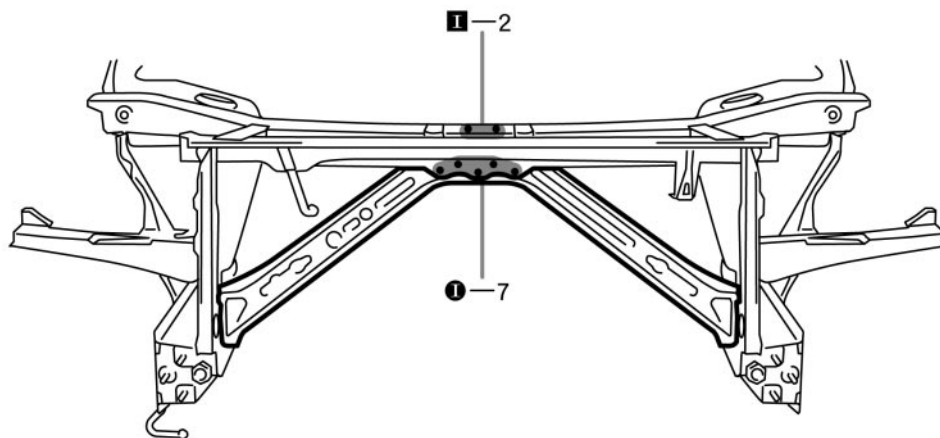

**2. INSTALL REAR DIAGONAL MEMBER**

**3. APPLYING SEALER TO THE ENGINE COMPARTMENT (See page PC-1)****4. APPLYING ANTI-RUST AGENT**

- (a) After applying the top coat layer, apply the anti-rust agent to the inside of the necked section structural weld spots.