

<b>Subject:</b>  CLUNK NOISE FROM DRIVE SHAFT	<b>Bulletin No:</b> 03-002/10
	<b>Last Issued:</b> 07/07/2010

## BULLETIN NOTE

- This bulletin supersedes the previous bulletin 03-002/10 issued on 3/8/10 and 6/30/10. The WARRANTY INFORMATION has been revised.
- Changes are noted below in Red beside the change bar.

## APPLICABLE MODEL(S)/VINS

2004-2008 Mazda3 with VINs lower than JM1BK\*\*\*\*\*899999 (produced through 08 mid-year change) and JM1BK\*\*\*\*\*158633 (produced before May 1, 2008)

2006-2008 Mazda5 with VINs lower than JM1CR\*\*\*\*\*321815 (produced before May 1, 2008)

2007-2008 CX-7 with VINs lower than JM3ER\*\*\*\*\*199186 (produced before December 3, 2007)

2007-2008 CX-9 with VINs lower than JM3TB\*\*\*\*\*141038 (produced before December 3, 2007)

2006-2008 MX-5 with VINs lower than JM1NC\*\*\*\*\*145220 (produced before November 5, 2008)

2004-2008 RX-8 with VINs lower than JM1FE\*\*\*\*\*215409 (produced before November 5, 2008)

## DESCRIPTION

Some vehicles may exhibit a clunk noise from the front drive shaft or the rear drive shaft when moving forward/backward from a stop. This is caused by a stick-slip noise due to excessive force created between the drive shaft and the wheel bearing. Grease is now applied between the drive shaft and the wheel bearing to correct this.

Customers having this concern should have their vehicle repaired using the following repair procedure.

## REPAIR PROCEDURE

1. Verify customer concern.

**NOTE:** For 2004-2005 Mazda3 with VINs lower than JM1BK\*\*\*\*\*271699 (produced before January 1, 2005), refer to Service Bulletin 03-003/05 - DRIVE SHAFT CLICK NOISE before proceeding with this Service Bulletin.

2. Remove the drive shaft according to MS3 online instructions.

3. Clean the drive shaft and the wheel bearing mating surface (A).

**NOTE:** Replace the nut (B) with a new one.

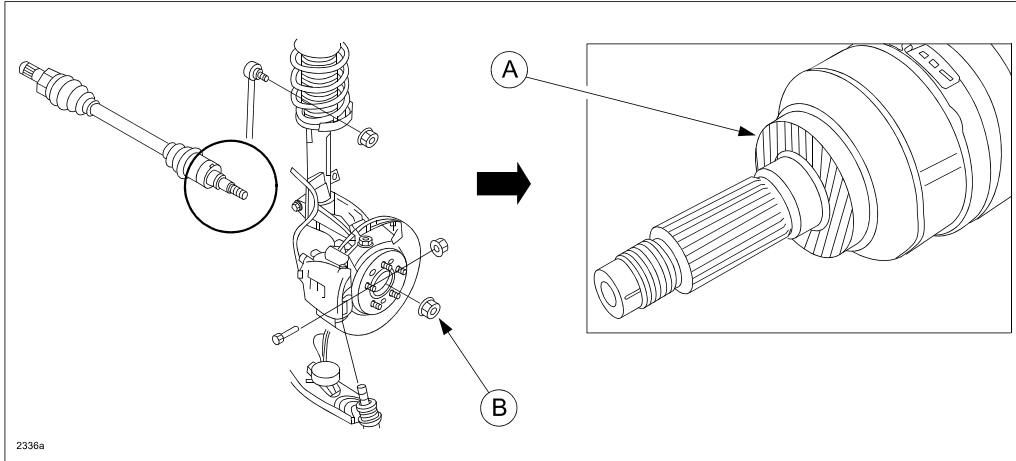

4. Apply molybdenum grease onto the drive shaft and wheel bearing mating surface (A).

**NOTE:** Be careful not to get grease on the brake disc/caliper.

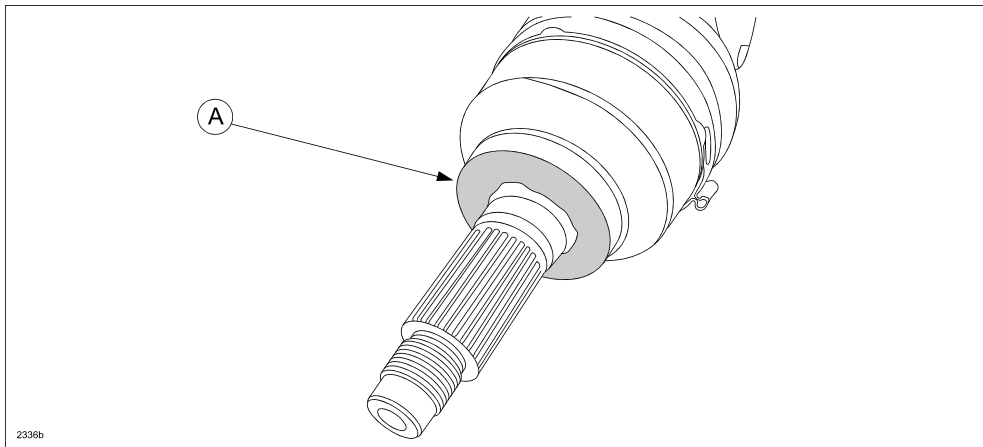

5. Install the drive shaft according to MS3 online instructions.  
6. Verify repair.

## PART(S) INFORMATION

Part Number	Description	Qty.	Notes.
L2Y1-33-247	Molybdenum grease	1	Grease can be used on 80 drive shafts (2 drive shafts per vehicle), and is included in the labor allowance. DO NOT claim this part number under Warranty.
****-33-042*	Nut	1	Refer to detailed part number on EPC.

## WARRANTY INFORMATION

### NOTE:

- This warranty information applies only to verified customer complaints on vehicles eligible for warranty repair.
- This repair will be covered under Mazda's New Vehicle Limited Warranty term for years 2004 - 2006.
- This repair will be covered under Mazda's New Vehicle Limited Warranty for a Powertrain Component for years 2007 - 2008. For RX-8, Powertrain coverage is for years 2004 - 2008.
- Additional diagnostic time cannot be claimed for this repair.
- The grease is included in the labor allowance. DO NOT claim this part number under Warranty.

Warranty Type	A
Symptom Code	82
Damage Code	92
Part Number Main Cause	****-33-047* (except Mazda5, RX-8, and MX-5) ****-26-151* (Mazda5, RX-8, and MX-5) Refer to detailed part number of wheel bearing on EPC.
Quantity	0
Operation Number / Labor Hours:	Refer to the following table.

Model	Trans	XXF0MARX (Right side)	XXF0MBRX (Left side)	XXF0MCRX (Both sides)
Mazda3	M/T/4AT	0.7 Hrs.	0.9 Hrs.	1.3 Hrs.
	5AT	0.7 Hrs.	1.1 Hrs.	1.5 Hrs.
Mazda5	M/T/4AT	0.7 Hrs.	0.9 Hrs.	1.3 Hrs.
	5AT	0.7 Hrs.	1.1 Hrs.	1.5 Hrs.
CX-7	-	0.8 Hrs.	0.8 Hrs.	1.3 Hrs.
CX-9	-	0.7 Hrs.	0.7 Hrs.	1.3 Hrs.
MX-5	-	0.8 Hrs.	0.8 Hrs.	1.4 Hrs.
RX-8	-	0.8 Hrs.	0.8 Hrs.	1.5 Hrs.