

FRONT SIDE MEMBER (ASSY)

REPLACEMENT

1. REMOVE RADIATOR UPPER SIDE SUPPORT (See page BP-1)
2. REMOVE RADIATOR UPPER SUPPORT (See page BP-3)
3. REMOVE FRONT SIDE MEMBER NO.1 REINFORCEMENT (See page BP-6)
4. REMOVE FRONT CROSSMEMBER (See page BP-9)
5. REMOVE FRONT FENDER APRON LOWER GUSSET (See page BP-36)
6. REMOVE FRONT FENDER APRON (See page BP-20)
7. REMOVE FRONT LUGGAGE END PANEL (See page BP-30)
8. REMOVE STEERING GEAR BOX SUPPORT MEMBER (See page BP-33)
9. REMOVE FRONT SIDE MEMBER
 - (a) After removing the front side member No.9 reinforcement, remove the front side member.

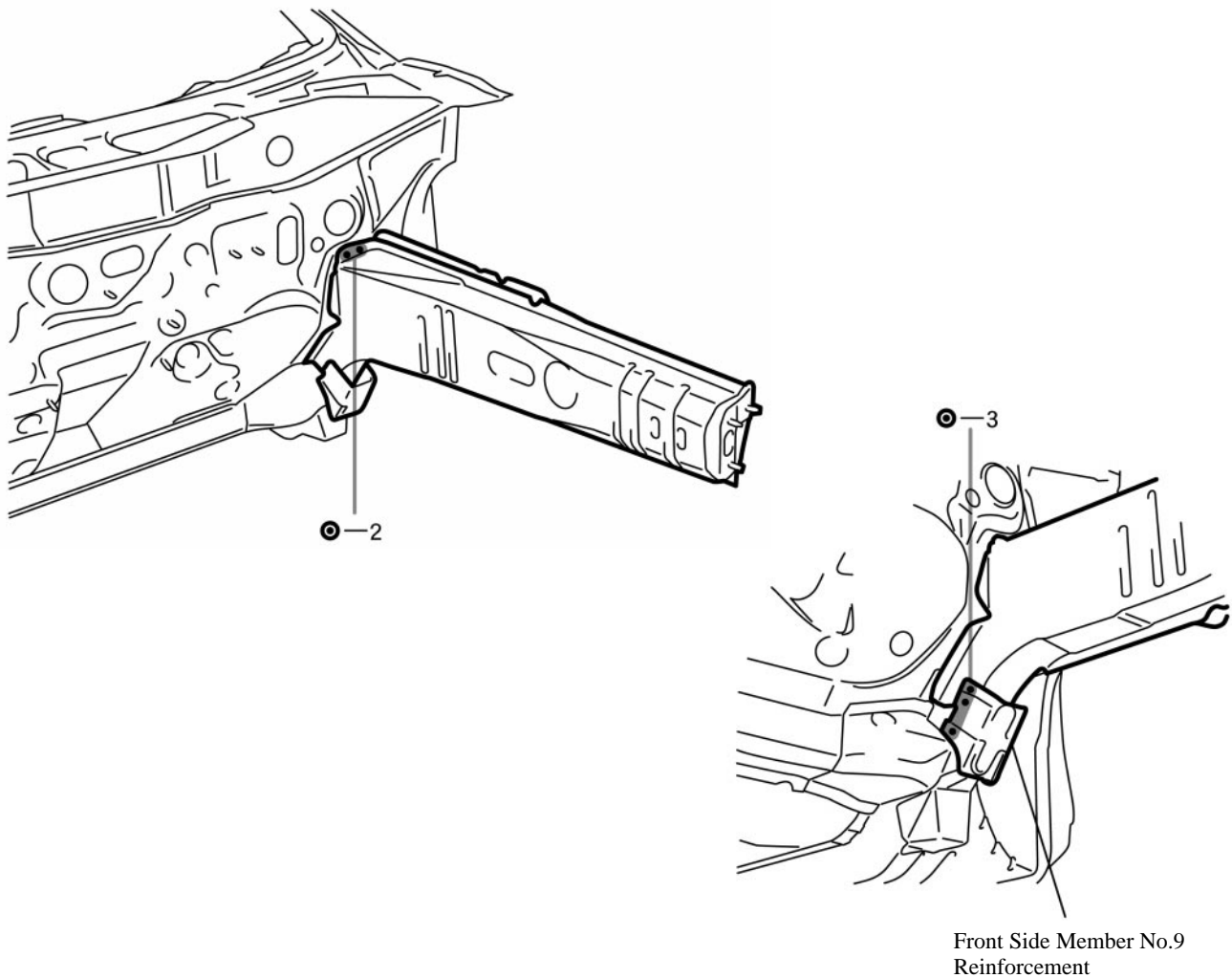

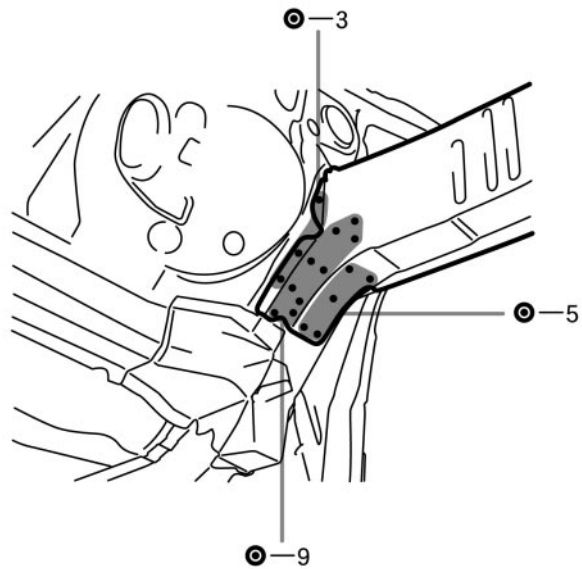
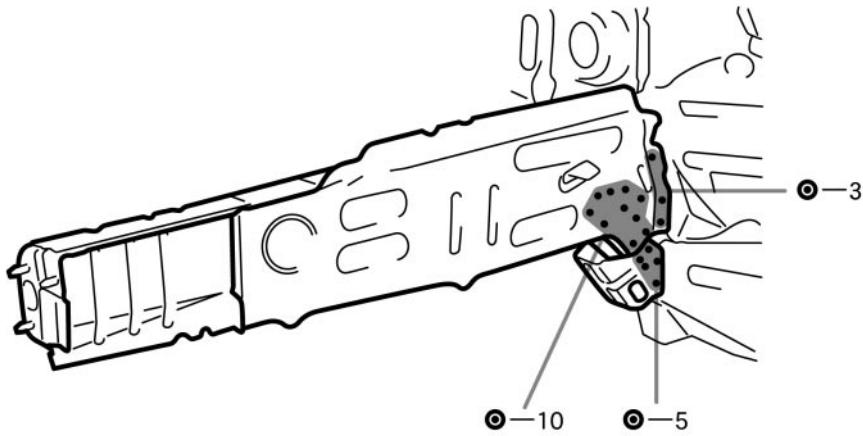

10. INSTALL FRONT SIDE MEMBER

- (a) Temporarily install the new parts and measure each part in accordance with the body dimension diagram.

HINT:

Make sure each measurement is correct, as this parts affects the front wheel alignment.

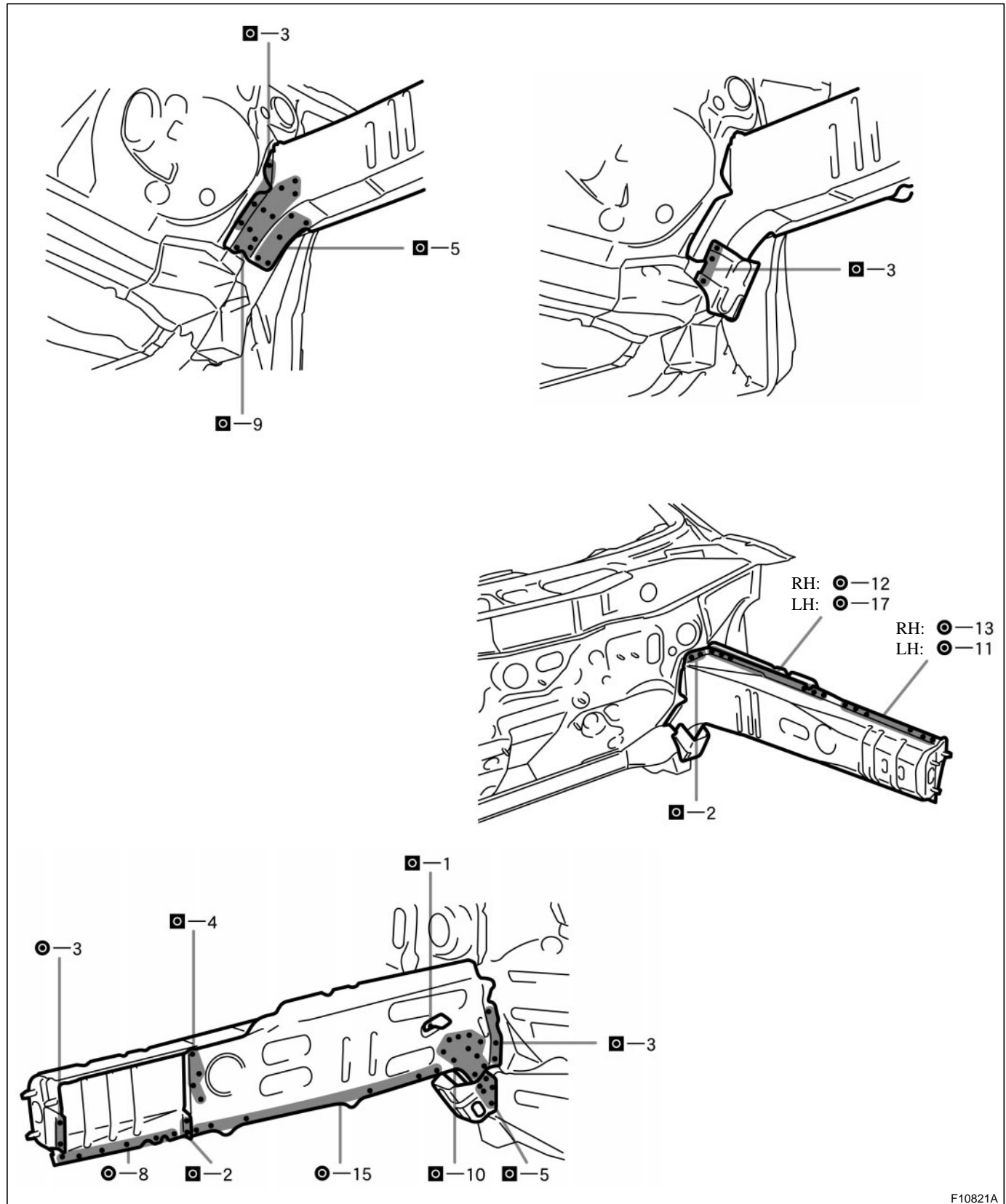

-
11. MEASURING THE FRONT LUGGAGE COMPARTMENT DIMENSIONS (See page BP-95)
 12. MEASURING THE UNDER BODY DIMENSIONS (See page BP-95)
 13. INSTALL STEERING GEAR BOX SUPPORT MEMBER (See page BP-34)
 14. INSTALL FRONT LUGGAGE END PANEL (See page BP-31)
 15. INSTALL FRONT FENDER APRON (See page BP-21)
 16. INSTALL FRONT FENDER APRON LOWER GUSSET (See page BP-37)
 17. INSTALL FRONT CROSSMEMBER (See page BP-10)
 18. INSTALL FRONT SIDE MEMBER NO.1 REINFORCEMENT (See page BP-7)
 19. INSTALL RADIATOR UPPER SUPPORT (See page BP-4)
 20. INSTALL RADIATOR UPPER SIDE SUPPORT (See page BP-2)
 21. APPLYING SEALER TO THE FRONT LUGGAGE COMPARTMENT (See page PC-1)
 22. APPLYING UNDER COATING (See page PC-6)
 23. APPLYING ANTI-RUST AGENT
 - (a) After applying the top coat layer, apply the anti-rust agent to the inside of the necked section structural weld spots.