

MOUNTING BRACKET (ASSY)

REPLACEMENT

1. REMOVE MOUNTING BRACKET

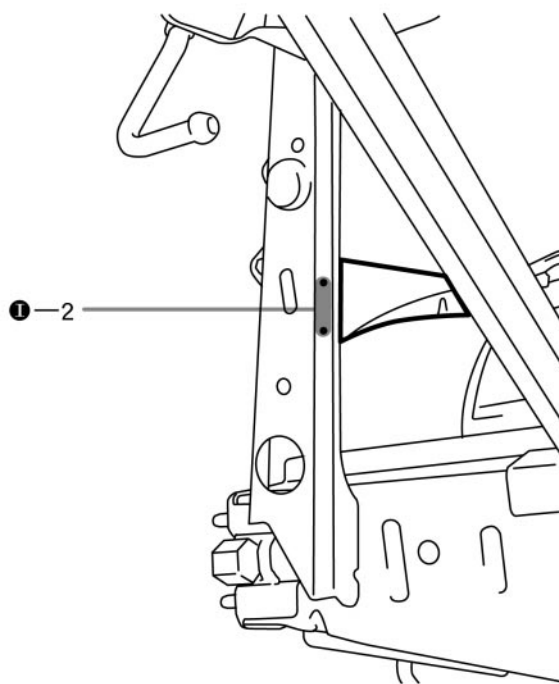
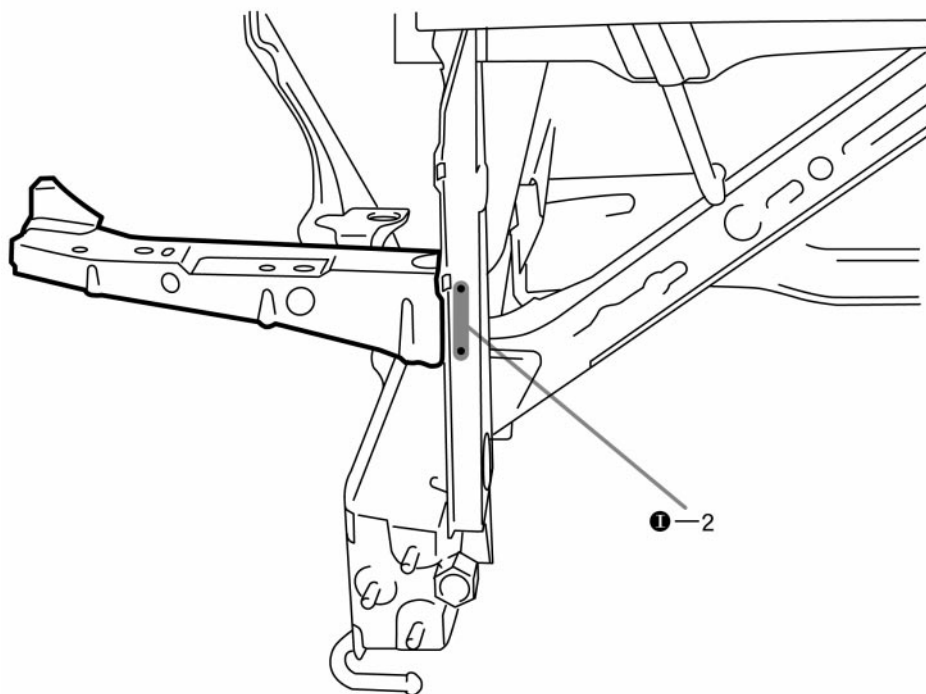

2. INSTALL MOUNTING BRACKET

- (a) Temporarily install the new parts and measure each part in accordance with the body dimension diagram.

HINT:

Inspect the fitting of the quarter panel and rear combination light etc., before welding, since this affects the appearance of the finish.

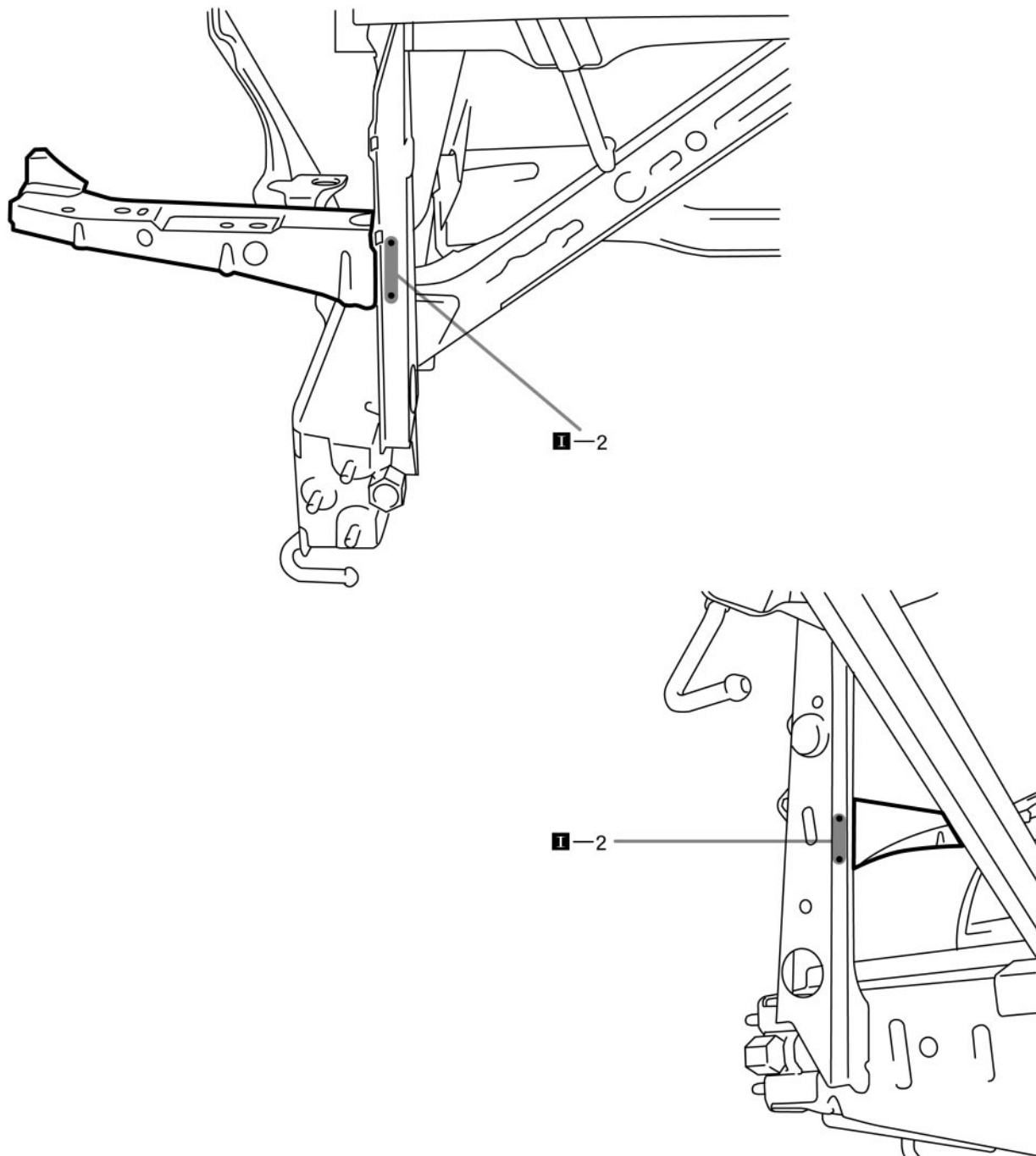

F10840A

3. APPLYING ANTI-RUST AGENT

- (a) After applying the top coat layer, apply the anti-rust agent to the inside of the necked section structural weld spots.