

QUARTER INNER REAR PANEL (ASSY)

REPLACEMENT

1. REMOVE LOWER BACK SIDE PANEL (See page BP-56)
2. REMOVE FRAME REAR UPPER CROSSMEMBER (See page BP-62)
3. REMOVE QUARTER INNER REAR PANEL

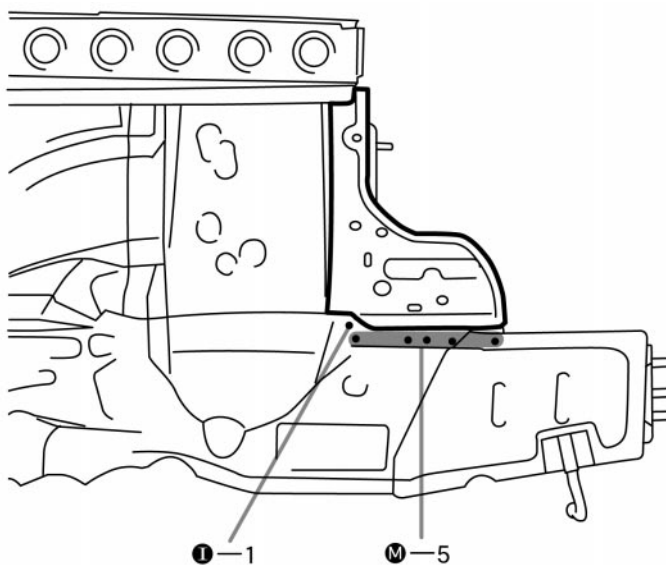
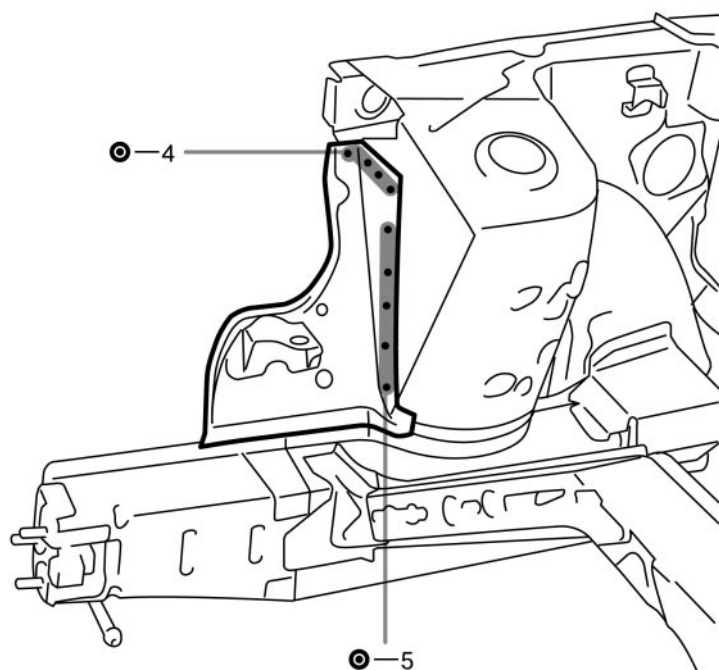
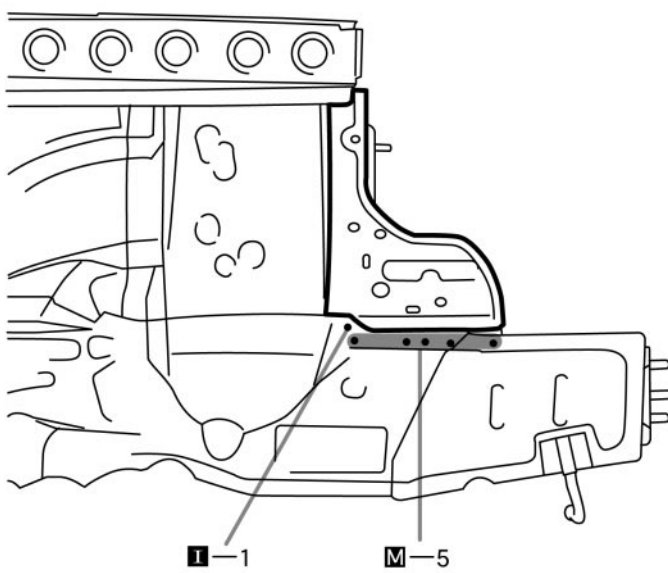
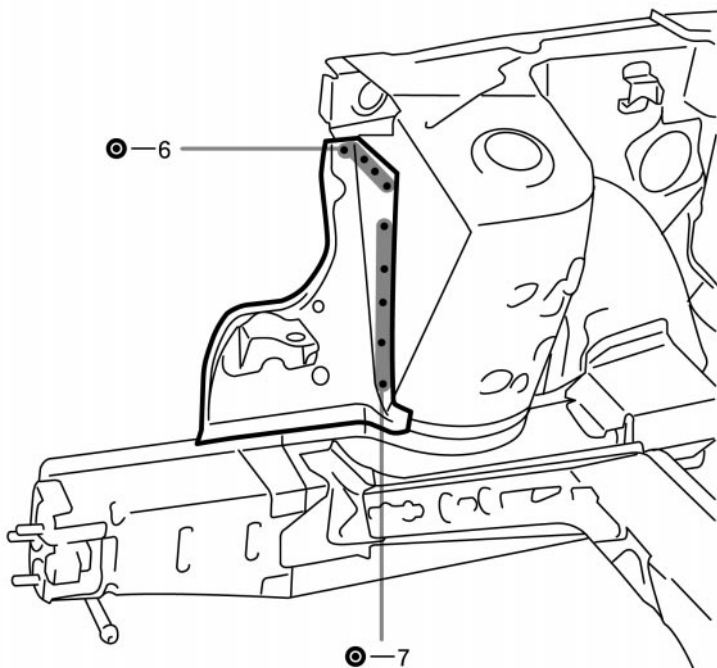

4. INSTALL QUARTER INNER REAR PANEL

-
5. **INSTALL FRAME REAR UPPER CROSSMEMBER (See page BP-63)**
 6. **INSTALL LOWER BACK SIDE PANEL (See page BP-57)**
 7. **APPLYING SEALER TO THE ENGINE COMPARTMENT (See page PC-1)**
 8. **APPLYING UNDER COATING (See page PC-6)**
 9. **APPLYING ANTI-RUST AGENT**
 - (a) After applying the top coat layer, apply the anti-rust agent to the inside of the necked section structural weld spots.